

This document is subject to the Arms Export Control Act (22 U.S.C. 7228) and the International Traffic in Arms Regulations (22 C.F.R. Parts 120-130). A prior authorization or license from the U.S. State Department Directorate of Defense Trade Controls is required to export, re-export, re-transfer, or show this document to any foreign person whether in the United States or abroad.

## UBR™ UTILITY/BATTLE RIFLE COLLAPSIBLE STOCK

UBR™ Installation & Usage Instructions  
for the AR15/M16 & AR10/SR25

**⚠ NOTICE: Observe safe firearm handling practices at all times. Failure to do so may result in grievous bodily injury or death. Magpul Industries shall not be responsible for injury, death or damage to property from misuse, illegal use or modification of this product.**

The UBR™ mounts to rifles using the included Entry Receiver Extension (Buffer Tube). Only a trained and qualified armorer/gunsmith should perform installation of this equipment. To avoid weapon damage, thoroughly review instructions before attempting installation. For armorer guidelines on original equipment removal, please refer to US Army TM 9-1005-319-23&P Unit and Direct Support Maintenance Manual.

MAGPUL® UBR™  
**STOCK MISSION & INFORMATION**

The Magpul UBR™ (Utility / Battle Rifle), U.S. Patents 6651371, 7152355, and other patents pending, is a fully-featured, adjustable butt stock for the AR15 / M16. Unlike typical collapsing stocks, this modular design offers the stability of a fixed stock with a consistent cheek weld in any position. Seven-position length-of-pull (LOP) adjustment is quickly executed with gross motor movement while the integral preset system allows direct access to a preferred position. A robust lock mechanism and multi-shell construction accommodates large-bore AR calibers while increasing durability and severe impact resistance. The UBR™ also provides extra counterbalance weight to improve handling on full-length rifles and weapons with muzzle-heavy accessories.

**SPECIFICATIONS**

WEIGHT (lb.)			
w/o BUTT PAD	w/ BUTT PAD	w/ BUTT PAD & RECEIVER EXTENSION	
1.31	1.40	1.56	

LENGTH OF PULL (Subtract 0.30" for LOP without rubber buttpad)								
P1	P2	P3	P4	P5	P6	P7	P8	
10.9"	11.4"	11.9"	12.4"	12.9"	13.4"	13.9"	14.4"	

\*LOP data for AR15/M16. Determined by measuring from trigger to back of stock.

Weight and LOP measurements may be altered by the addition or removal of accessories such as QD Sling Mounts, Butt Pads, Storage Doors, Cheek Risers, Strike Plate, etc.

**OPTIONS & ACCESSORIES**

The UBR™ is available in Black, Flat Dark Earth, Foliage Green, and OD Green, and can be configured with a wide range of options and accessories depending on user needs. For customizing instructions using included accessories, see pages 9-10. For more information or to purchase these and other accessories, visit [www.magpul.com](http://www.magpul.com) or any Magpul dealer.

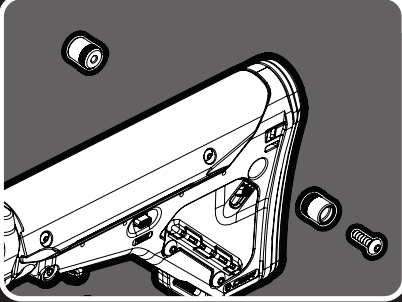

**Ambidextrous Front and Rear QD**

Although the standard QD Sling Cups can be installed on either side of the stock for right or left handed shooters, dual-side ambidextrous QD Sling Sockets are available for shooters seeking greater carrying flexibility. Fits front or rear.

MAG332 / \$19.95



**Enhanced Buttpad**

The 0.70" thick Carbine Recoil Pad allows users to increase length of pull and help mitigate recoil on larger caliber weapons such as the AR-10/SR-25, shotguns, and new "wildcat" large-bore AR calibers.

MAG317 / \$19.95

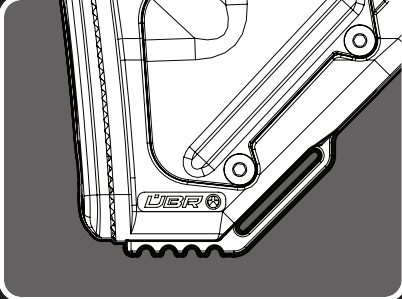

**Aluminum Strike Plate/Sling Loop**

With the inclusion of the new metal strike plate the operator will now have an increased capability in a close quarter combatives environment. The all metal sling loop and large serrations coupled with the already robust design of the UBR give the operator a truly formidable impact weapon.

The new strike plate also increases the utility of the UBR, giving the operator the ability to perform in extremis "break and rake" and breaching actions.

MAG331 / \$24.95

# INSTALLATION INSTRUCTIONS



## STEP 1: Remove Original Stock

**WARNING: BEFORE BEGINNING, MAKE SURE THE WEAPON IS UNLOADED, THE CHAMBER IS EMPTY, AND THE SAFETY ENGAGED.**

Remove *Upper Receiver* from the weapon. Depress *Buffer Retaining Pin* and remove the *Buffer* and *Action Spring*. Remove original stock using care to prevent losing the *Takedown Pin Spring* and *Detent*. See Step 2 below.

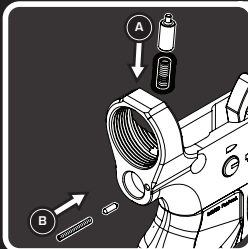

## STEP 2: Remove Original Receiver Extension

Remove *Receiver Extension* (buffer tube) making sure to retain the *Buffer Retaining Pin/Retaining Pin Spring* (A) and *Takedown Pin Spring/Takedown Pin Detent* (B). NOTE: If you have an A1/A2 fixed stock using a rifle-length receiver extension, the buffer and spring must also be replaced in addition to the receiver extension. See Step 7 for more information.

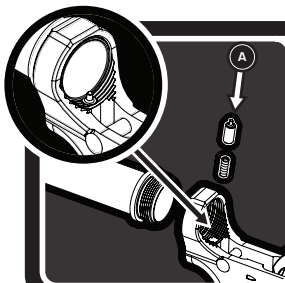

## STEP 3: Mount Entry Receiver Extension

Make sure *Buffer Retaining Pin* and *Retaining Pin Spring* (A) are correctly placed inside the *Lower Receiver*. Depress and hold the *Buffer Retaining Pin* while screwing *Entry Receiver Extension* into lower. Tighten with armorer's wrench (5/8") 35-39 ft-lb. torque per US Army TM 9-1005-319-23&P Unit and Direct Support Maintenance Manual. NOTE: DO NOT USE LOCTITE® OR OTHER LOCKING COMPOUND ON RECEIVER EXTENSION THREADS.

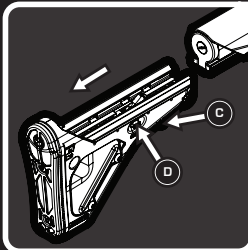

## STEP 4: Remove Stock Body

Bypass all presets (see page 7) and open stock to the last position marked "6". Firmly hold the *Stock Body* and simultaneously depress the *Release Latch* (C) while pushing the *Remove Button* (D) from the right. Pull the *Stock Body* off the *Main Tube Assembly*.

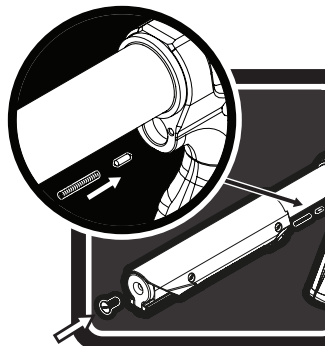

## STEP 5: Mount UBR™ Main Tube

Verify the *Takedown Pin Spring* and *Detent* are placed correctly in the *Lower Receiver*. Slide the *UBR™ Main Tube Assembly* over the *Entry Receiver Extension*. Take care to avoid damaging the exposed detent spring and make sure it does not bind when seating the *Main Tube*. If necessary, use a soft rubber mallet to seat fully the *Main Tube Assembly*. Install *UBR™ Butt Cap Screw* with a flat-head screwdriver until hand tight. DO NOT use any other screw to mount UBR™ as it may damage stock or affect weapon cycling.

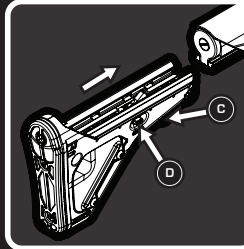

## STEP 6: Attach UBR™ Stock Body

Pull back and hold the *Release Latch* (C) on the *UBR™ Stock Body*. Align *Stock Body* with *Main Tube Assembly* and gently slide parts together until the *Stock Body* stops (travels forward about 2.75"). DO NOT FORCE PARTS TOGETHER. Let go of *Release Latch* (C). Push *Remove Button* (D) and slide *Stock Body* forward until it clicks into place. Release all controls. Pull back fully on *Release Latch* (C) and push forward on *Stock Body* to collapse stock.

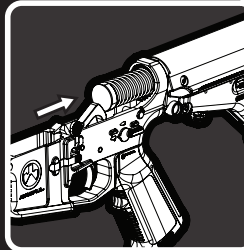

## STEP 7: Install Buffer and Spring

Install *Carbine Buffer* (standard, H, H2, etc.) and *Carbine Action Spring*. NOTE: Rifle buffers and action springs (like those used in fixed A1/A2 stocks) DO NOT function with the UBR™.

AR10/SR25 ONLY: The UBR™ may be used with most 7.62 NATO rifles but requires the use of a special AR10 Carbine Buffer and Action Spring. Please contact [techsupport@magpul.com](mailto:techsupport@magpul.com) for more information.

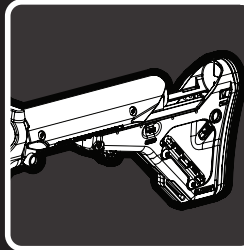

## STEP 8: Verify Installation

Make sure all screws are tight. Avoid over-tightening screws as this can permanently damage the stock. Reassemble the weapon and perform final inspection and function check per US Army TM 9-1005-319-23&P Unit and Direct Support Maintenance Manual. If you experience any issues during installation please visit the "Tech Resources" section at [www.magpul.com](http://www.magpul.com) for further information. Always test fire your weapon before using it in an operational environment.

## FEATURES &amp; CONSTRUCTION

**Stationary Cheek Piece** ①

Cheek piece allows for a consistent cheek weld for comfortable use of sights/optics and nose-to-charging handle (NTCH) shooting regardless of stock position.

**Release Latch** ②

Release latch for LOP adjustment.

**Front QD Mount** ③

Single-side front quick-disconnect sling mount. Can be re-mounted on opposite side for left-handed shooters (see page 9). Ambidextrous QD mounts optional.

**Receiver Key**

Interfaces with lower receiver keyway for easy installation and positive stock orientation.

**Rear QD Mount** ④

Single-side rear quick-disconnect sling mount. Can be re-mounted on opposite side for left handed shooters. Ambidextrous QD mounts optional.

**Storage Door** ⑤

Storage door can be switched to opposite side for left-handed shooters or removed altogether. See page 9 for more information.

**Rubber Butt Pad** ⑥

0.30" thick Rubber Butt Pad. See page 10 for more information.

**Garrison Sling Loop** ⑦

Can be replaced with optional Aluminum Strike Plate.

**Preset & Remove Buttons** ⑧

Adjustable LOP preset system allows direct access to one of five (5) presets for quick adjustment to a preferred position. Remove Button on opposite side allows Stock Body to be easily removed from Main Tube Assembly.



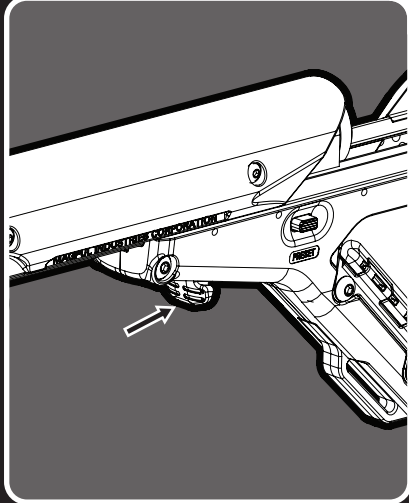

#### Extend / Collapse Stock

Fully depress the *Release Latch* and pull the stock rearward to extend, or push stock forward to collapse. The stock will extend until it hits either a preset stop (factory set at position "P5") or the back stop. Intermediate positions may be selected by partially depressing the *Release Latch* and ratcheting the stock back to the desired position. Let go of the *Release Latch* and push *Stock Body* forward to properly seat the locking mechanism.

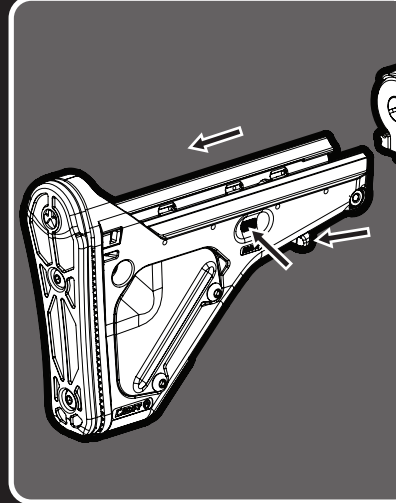

#### Detach Stock Body

To remove the stock, bypass all presets (see previous page) and open the stock to the last position marked "6". Firmly hold the *Stock Body* and simultaneously press the *Release Latch* while pushing the *Remove Button* from the right. Pull the *Stock Body* off the *Main Tube Assembly*.

To reinstall *Stock Body*, simultaneously depress *Release Latch* and *Remove Button* while sliding *Stock Body* back on to *Main Tube Assembly*. See Step 6 on page 4 for more detailed instructions.

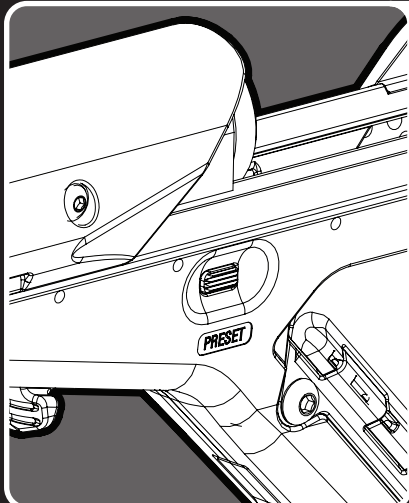

#### Bypass Preset

To bypass a *Preset* when extending the stock, pull stock rearward while simultaneously depressing the *Release Latch* and pushing the *Preset Button* located on the left side. All presets are automatically bypassed when collapsing the stock - simply use the *Release Latch* and collapse to desired position.

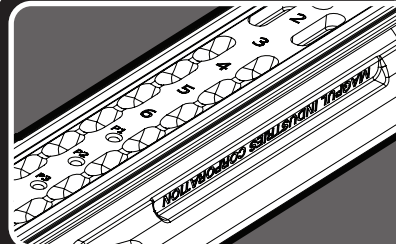

#### Cleaning & General Maintenance

See above for *Stock Body* detachment instructions.

##### MAIN TUBE ASSEMBLY

Clean inside rails and locking grooves using a nylon brush or rag. WIPE OFF ANY OIL, CLP OR CLEANING SOLVENTS AS THESE MAY ATTRACT DUST AND GRIME.

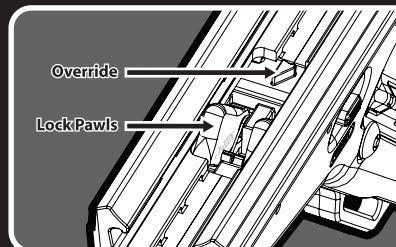

##### SLIDING STOCK BODY

Use a nylon brush or rag to remove dust, dirt or debris from inside the rails, grooves and locking mechanism. Apply a light amount of oil to *Lock Pawls* and *Override* to provide smooth function. If necessary, use graphite lubricant in dry, dusty environments.

## CUSTOMIZATION INSTRUCTIONS

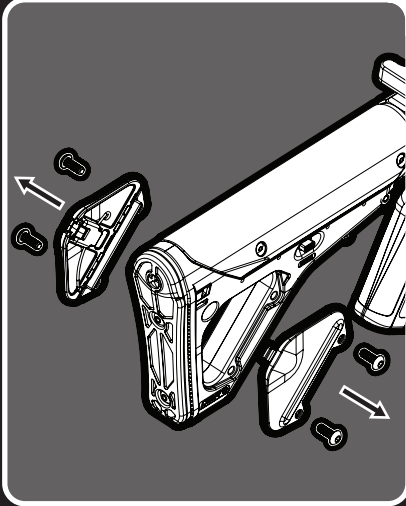

## Storage Removal/Adjustment

The *Storage Door* and *Cover* may be swapped from left to right, or removed completely to adjust for user preference. To reconfigure the storage door, use a 1/8" Hex Key to remove the four (4) 10-24 x 1/2" *Button Head Screws*. Swap door and cover and reinstall screws. To remove the storage doors completely, replace the screws with the shorter 10-24 x 3/8" *Button Head Screws* (included).

**NOTE: THE UBR™ REQUIRES THE INSTALLATION OF ALL FOUR (4) SCREWS FOR CORRECT OPERATION. DO NOT RE-INSTALL 10-24 x 1/2" SCREWS WITHOUT STORAGE DOOR AND COVER INSTALLED.**

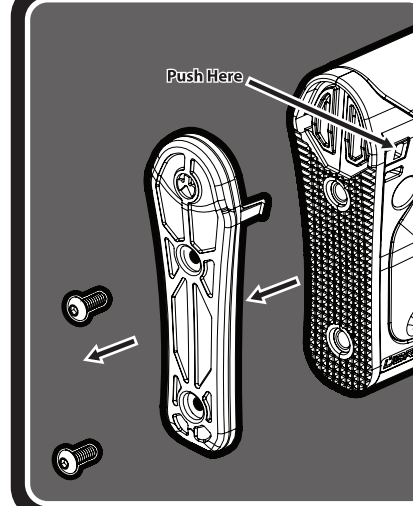

## Rubber Butt Pad Removal

The 0.30" *Rubber Butt Pad* is held in place by two screws and two polymer snap hooks (one on each side). To remove or replace the pad, first use a 1/8" Hex Key to remove the two 10-24 x 5/8" *Button Head Screws*. Next, use two small screwdrivers or bullet tips (in locations shown) to push snap hooks inward. This will release the pad for removal.

For use without the Butt Pad, a checkered *Butt Cap* is available to fill the void located above the screw hole.

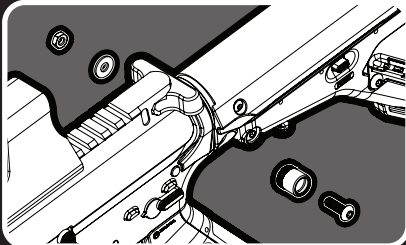

## QD Removal/Installation

**REMOVE FRONT MOUNT:** Using a 1/8" Hex Key and a 5/16" Hex Socket remove 10-24 x 5/8" *Button Head Screw*, *Hex Nut*, and *Washer*. Use 1/4" *Pin Punch* to remove *QD Mount Cup*. If desired, install on right side of *Receiver Key* in opposite manner. For complete removal substitute spare washer in place of *QD Mount* and reinstall original washer, screw and nut. **NEVER REMOVE THE RECEIVER KEY!**

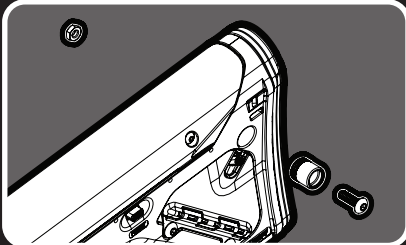

**REMOVE REAR MOUNT:** Remove 10-24 x 5/8" *Button Head Screw* and *Hex Nut*. Carefully use a *Push-Button QD Sling Swivel* to pull out the rear *QD Mount Cup*. Reinstall screw and nut or install cup on right side of stock in opposite manner. **DO NOT USE WASHERS IN REAR HOLE AS THEY WILL BECOME JAMMED INTO POLYMER.**

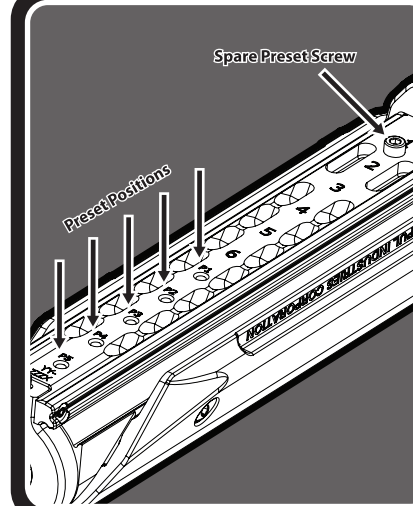

## Preset Adjustment

Remove *Stock Body* to reveal *Preset Locations* on the bottom side of the *Main Tube Assembly*. Install *Preset Screw* (5-40 x 1/4" socket head cap screw) in one of the positions marked "P1" to "P5" to adjust the favored position. The spare preset screw can be used to set a second preset position or as a replacement for a lost preset screw.